

100 SERIES 3/2 WOODRAKE GRAPPLE

Open	62"	1575 mm
Area tip to tip	4.1 ft ²	0.38 m ²
Cylinder Bore	3"	76 mm
Lock valve on Cylinder	Excluded	
Cylinder Max. Pressure	3000 psi	207 bar
Weight (grapple only)	830 lb	376 kg

075 SERIES MANIPULATING ROTATOR

Rotation	Unlimited	
Lifting capacity	20233 lb	9178 kg
Max pressure	3625 psi	250 bar
Torque at max. pressure	36000 lb-in	4067.5 Nm
Rotator flow	8 gpm	30 L/min
Rotation speed	30 rpm	
Weight	201 lb	91 kg

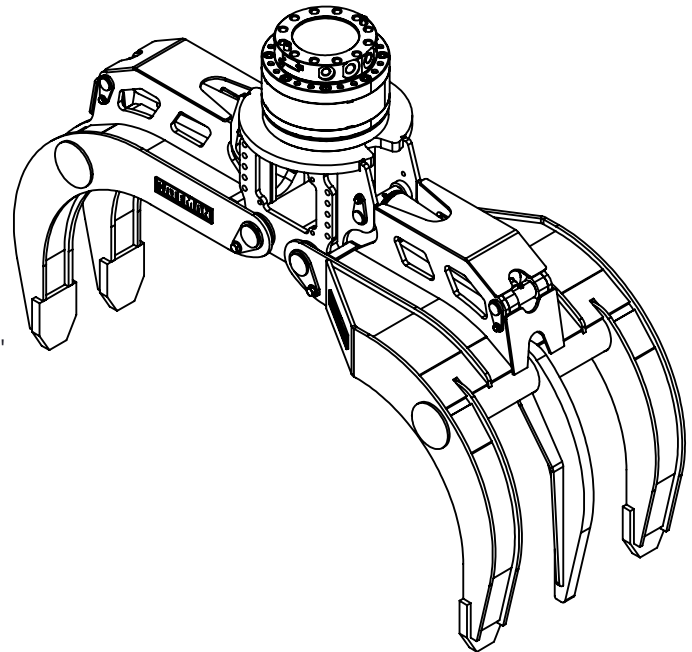
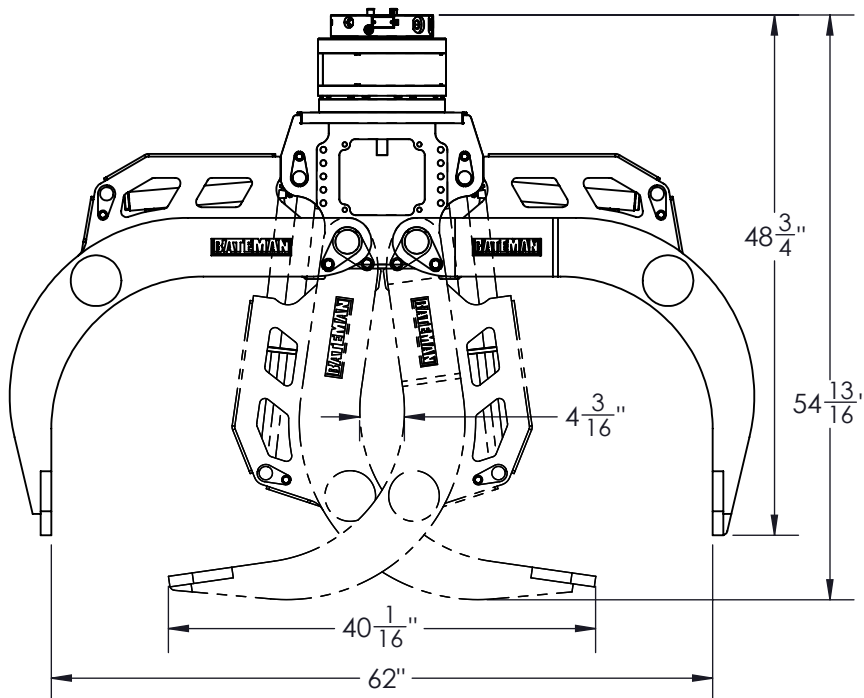

BATEMAN MANUFACTURING
5 WINSTAR ROAD
ORO-MEDONTE, ONTARIO
LOL 2L0, CANADA

WWW.BATEMANMANUFACTURING.COM
MAIL@BATEMANMANUFACTURING.COM
PHONE: (705) 487-5020
FAX: (705) 487-5290

BATEMAN
A GRYB COMPANY